

CONNETTORE SENSORI 5 CONTATTI M12  
SENSOR CONNECTOR 5 PIN M12

CONNETTORE DI POTENZA IT 3102 A  
POWER CONNECTOR IT 3102 A

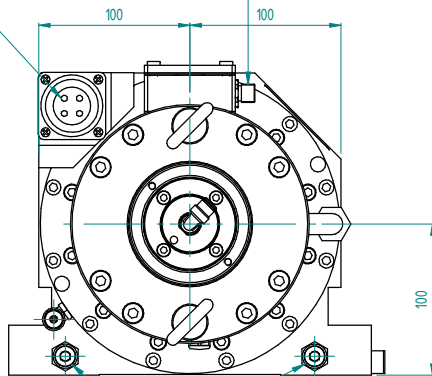

LIQUIDO DI RAFFREDDAMENTO IN - OUT (PRESSIONE 4 - 6 bar)  
LIQUID COOLING IN - OUT (PRESSION 4 - 6 bar)

PRESSURIZZAZIONE: E4 Aria secca 6-6,5 bar  
PRESSURIZATION: E4 Dry air 6-6,5 bar

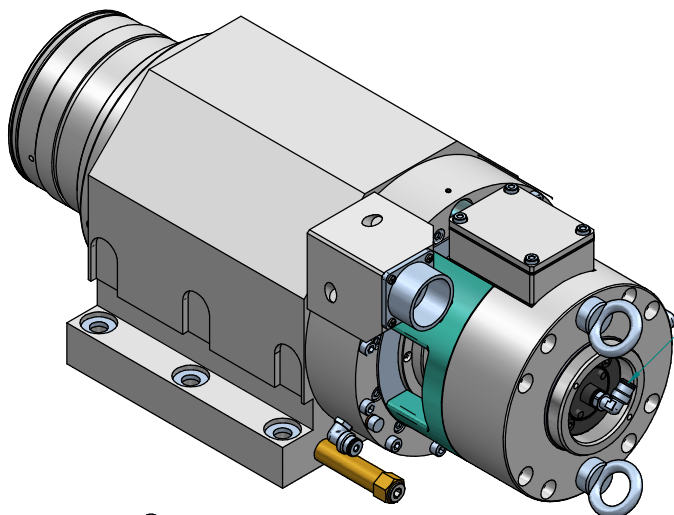
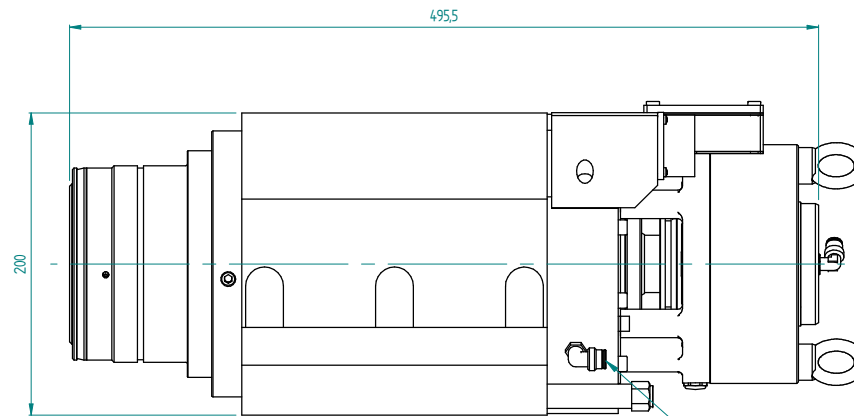

SOFFIO CONO : E6 6-6,5 bar  
TAPER CLEANING : E6 6-6,5 bar

SBLOCCO UTENSILE: G3/8 Olio 80-85 bar  
RELEASE TOOL: G3/8 Oil 80-85 bar

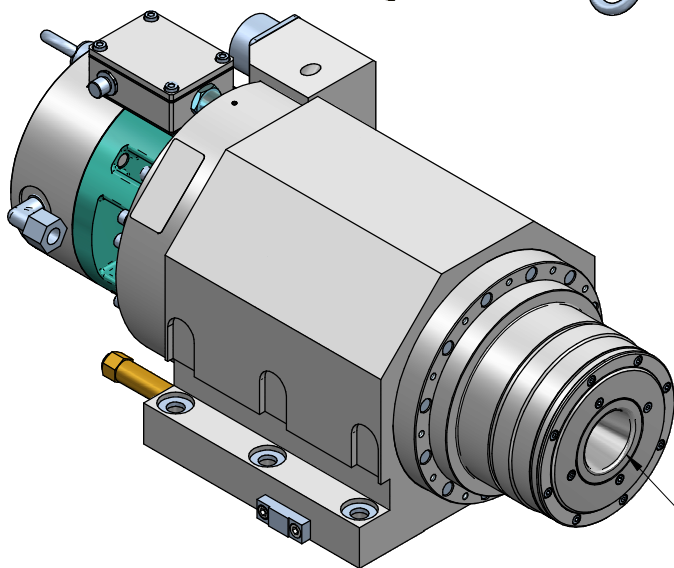
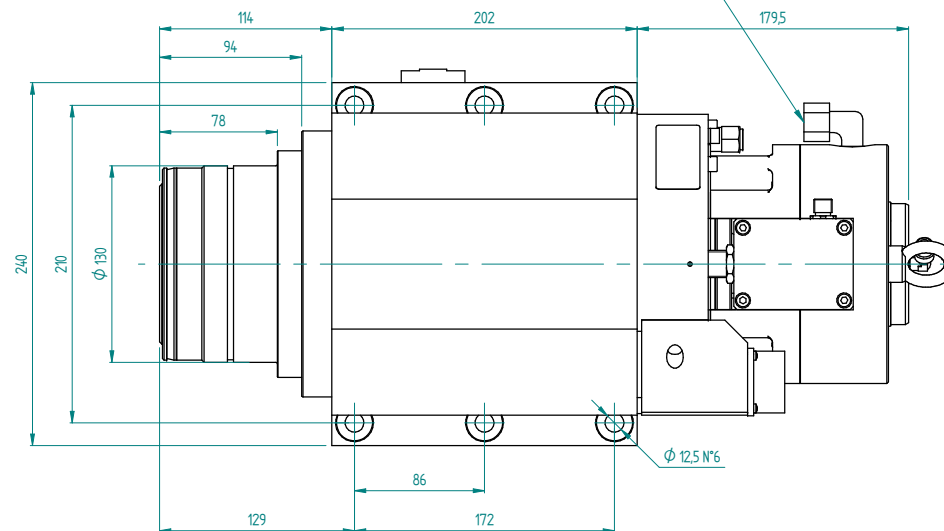

TIRANTE DIN 69872  
PULL-STUD DIN 69872

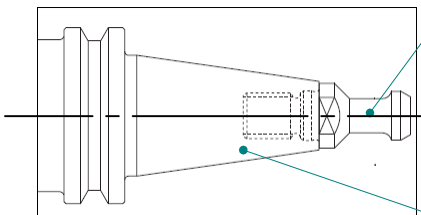

CONO ISO40 DIN 69871  
TAPER ISO40 DIN 69871

**ATTACCO ISO40 DIN69871  
TOOL INTERFACE ISO40 DIN69871**

Riv. Data / Date		Firma / Signature		Descrizione ultima modifica / Last change description		N° Modifica / Change ID	
Ultimo rilascio / Latest release		Firma / Signature		Rugosità / Roughness		Trattamento Termico / Heat Treatment (SCM specifications ST234D TG)	
Controllo / Checked by		Data / Date		Smussi / chamfer		Peso grezzo/Raw weight (kg) 0	
Disegnato / Designed by		31/10/2018		Massa / Mass (kg) 74,739		Ricaricare da o Stato di fornitura / Based on or State of supply	
Denominazione / Item Name		ELETM MG-2 9/6 15 140 NC		Codice / Item ID		29L0495022H	
Scala / Scale		1:5		Rev		00	
Tav. N. di N.		2/2		Status			



© RIPRODURRE È TERMINATA LA PROPRIETÀ DI QUESTO DISEGNO CONDIVISO CON I CLIENTI. È CONSIDERATA COME UNO DEI TERZI SENZA ALCUNA PRESENTAZIONE APPROVAZIONE. THIS DRAWING IS SCM PROPERTY. COPYRIGHTED MATERIAL. DISCLOSED TO THIRD PARTIES WITHOUT OUR AUTHORIZATION IS EXPRESSLY FORBIDDEN.