

TARGHETTA IDENTIFICATIVA  
cod.03L0502711C

ATTACCO HSK 63E  
TOOL INTERFACE HSK 63E  
DIN69893-5

PUNZONARE SU CARCASSA  
STAMP ON HOUSING  
HY XXXX YY/ZZ  
XXXX = NUMERO SERIALE - SERIAL NUMBER  
YY = MESE DI PROD. - MONTH OF PROD.  
ZZ = ANNO DI PROD. - YEAR OF PROD.

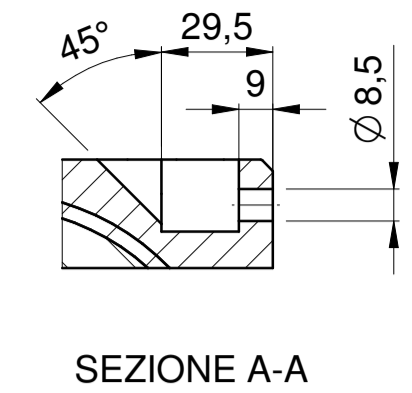
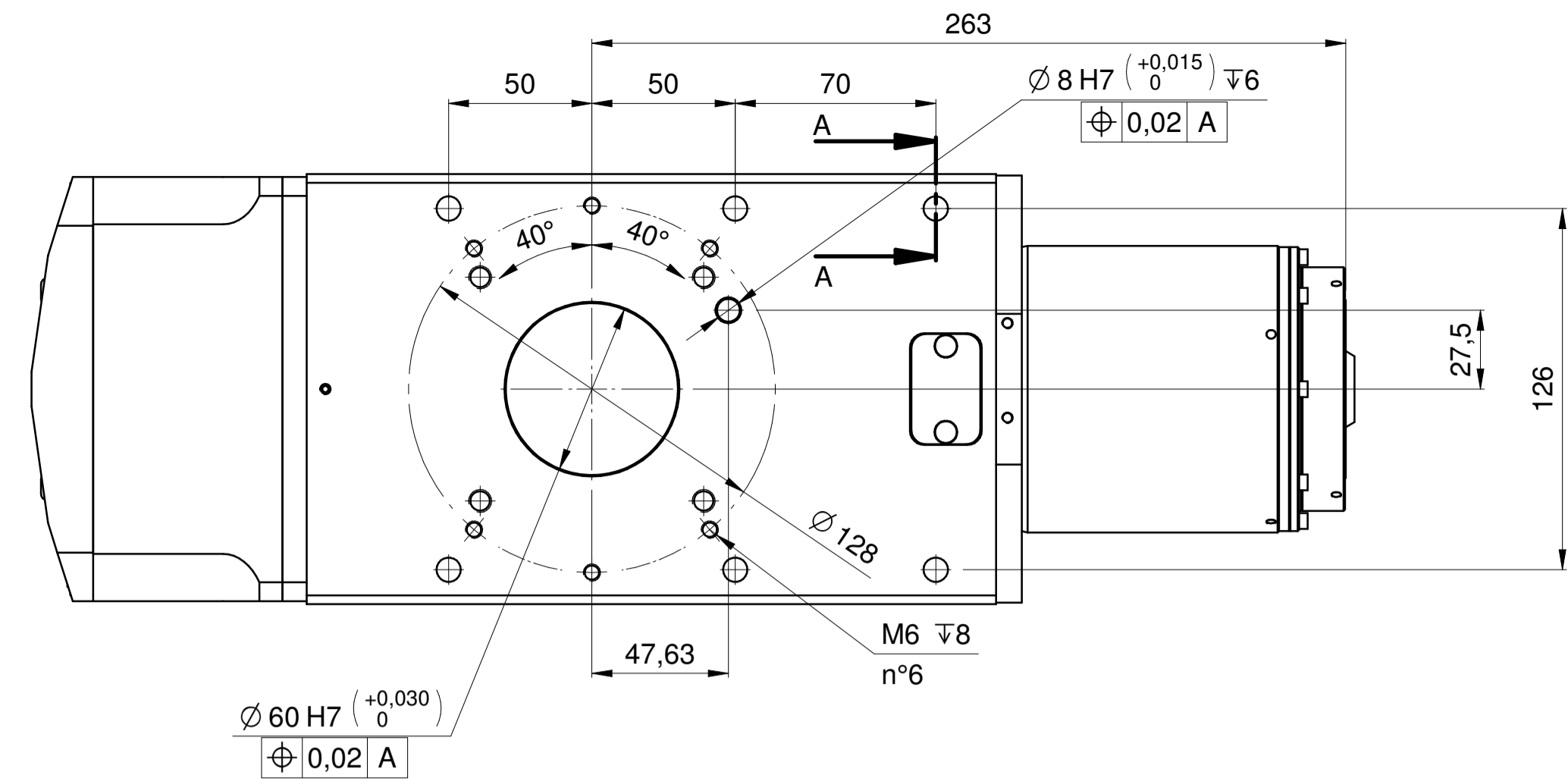
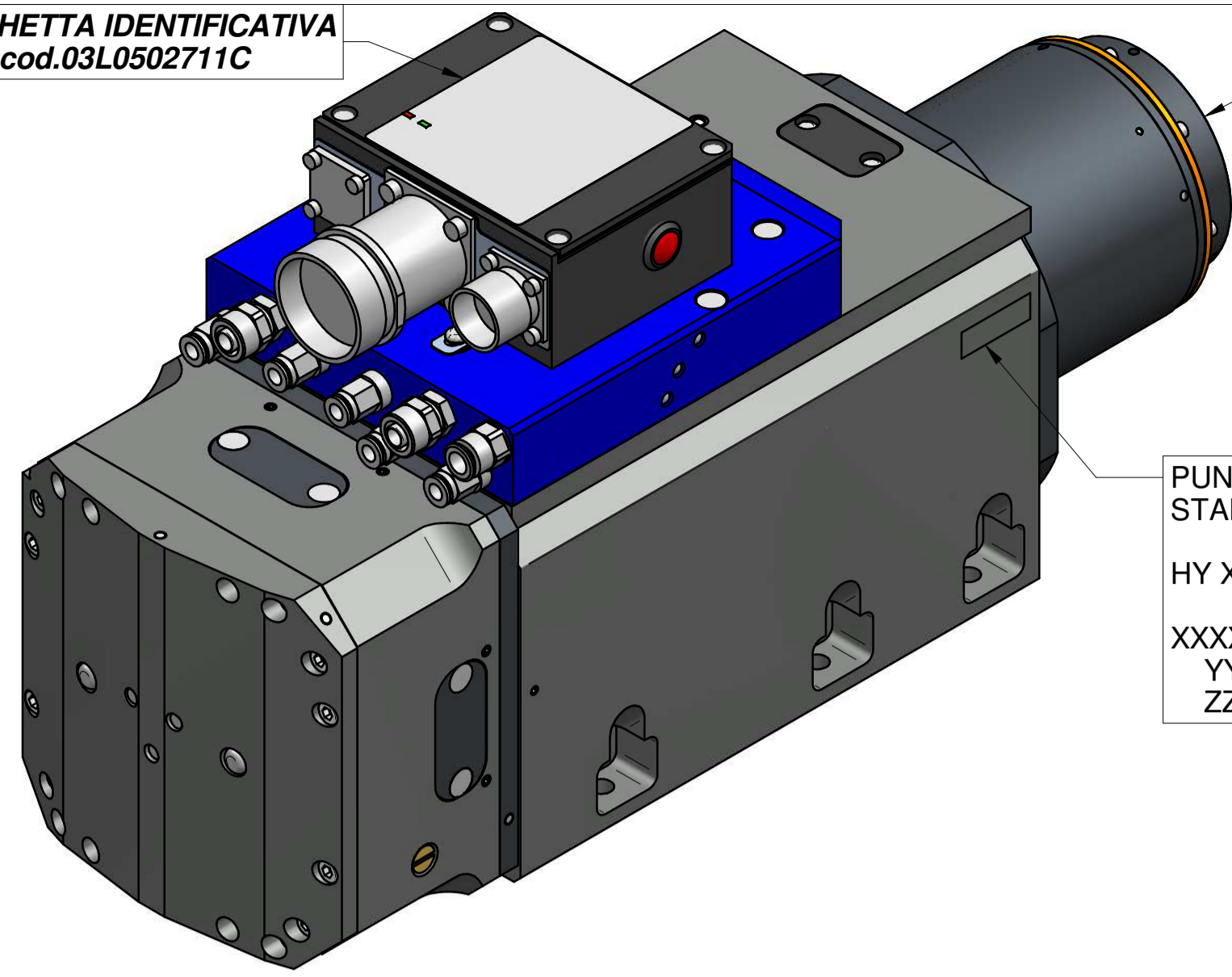

SEZIONE A-A

**CAVI CONNETTORE POTENZA - POWER CONNECTOR**

Rif.	DESCRIZIONE	COLORE	SEZIONE
U	U - FASE MOTORE - MOTOR PHASE	NERO - BLACK	2,5mmq
V	V - FASE MOTORE - MOTOR PHASE	BLU - BLUE	2,5mmq
W	W - FASE MOTORE - MOTOR PHASE	MARRONE - BROWN	2,5mmq
GND	GND	GIALLO-VERDE - YELLOW-GREEN	2,5mmq
-	N.C.		
+	N.C.		

**ELENCO SERVIZIO CONNESSIONI PNEUMATICHE**

Rif.	DESCRIZIONE	TUBO	DATI
A	UTENZA PNEUM./IDRAUL. 3 - AIR/HYDRAULIC INLET 3	φ 6	6 - 6,5 bar
B	INGRESSO/USCITA LIQUIDO DI RAFFREDDAMENTO ELETM - IN/OUT LIQUID COOLING ELECTROSPINDLE	φ 10	4,5 U/min
C	UTENZA PNEUM./IDRAUL. 1 - AIR/HYDRAULIC INLET 1	φ 6	6 - 6,5 bar
D	UTENZA PNEUM./IDRAUL. 2 - AIR/HYDRAULIC INLET 2	φ 6	6 - 6,5 bar
E	UTENZA PNEUM./IDRAUL. 4 - AIR/HYDRAULIC INLET 4	φ 6	6 - 6,5 bar
F	INGRESSO/USCITA LIQUIDO DI RAFFREDDAMENTO ELETM - IN/OUT LIQUID COOLING ELECTROSPINDLE	φ 10	4,5 U/min
G	SOFFIO COND / PRESSURIZZAZIONE - TAPER CLEANING / PRESSURIZATION	φ 6	4 - 4,5 bar
H	SBLOCCO - RELEASE TOOL	φ 8	9,5 - 10,5 bar

**CONNETTORE SEGNALE I/O - SIGNAL I/O CONNECTOR**

PIN	DESCRIZIONE - DESCRIPTION	COLORE - COLOR	Sez.
1	N.C.	-	0,14mmq
2	N.C.	-	0,14mmq
3	+24 Vcc ALIM. S3 - SUPPLY S3	BLU - BLUE	0,14mmq
4	0 Vcc ALIM. S3 - SUPPLY S3	NERO - BLACK	0,14mmq
5	OUTPUT S1 - UTENSILE AFFERRATO - TOOL LOCKED	MARRONE - BROWN	0,14mmq
6	OUTPUT S2 - UTENSILE SBLOCCATO - TOOL RELEASED	VIOLA - VIOLET	0,14mmq
7	OUTPUT S3 - ROTAZIONE ALBERO - SHAFT ROTATION	ROSSO - RED	0,14mmq
8	0 V - ALIM. S1+S2 - SUPPLY S1+S2	VERDE + ROSA - GREEN + PINK	0,14mmq
9	+24 Vcc ALIM. S1+S2 - SUPPLY S1+S2	BIANCO + GIALLO - WHITE + YELLOW	0,14mmq
10	OUTPUT S5 - RITORNO PISTONE - PISTON BACK	GRIGIO - GRAY	0,14mmq
11	OUTPUT Sonda Termica - THERMAL ALARM	BIANCO - WHITE	0,14mmq
12	N.C.	-	
13	+24V Sonda Termica + Pulsante C.U. - THERMAL ALARM + T.C. BUTTON	NERO + BIANCO - BLACK + WHITE	0,14mmq
14	OUTPUT Pulsante C.U. - T.C. BUTTON	NERO - BLACK	0,14mmq
15	N.C.	-	
16	N.C.	-	
17	N.C.	-	

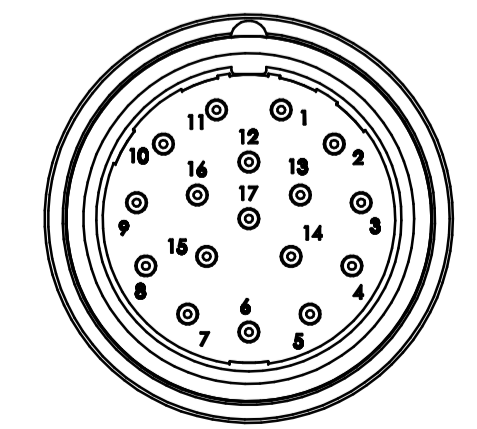
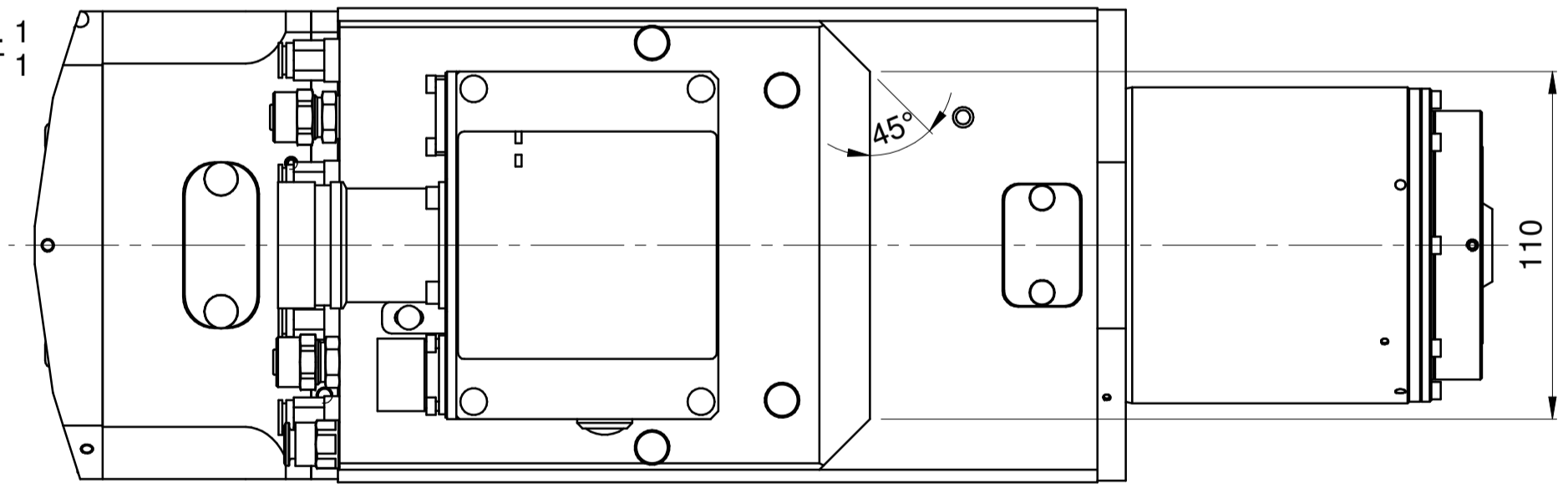
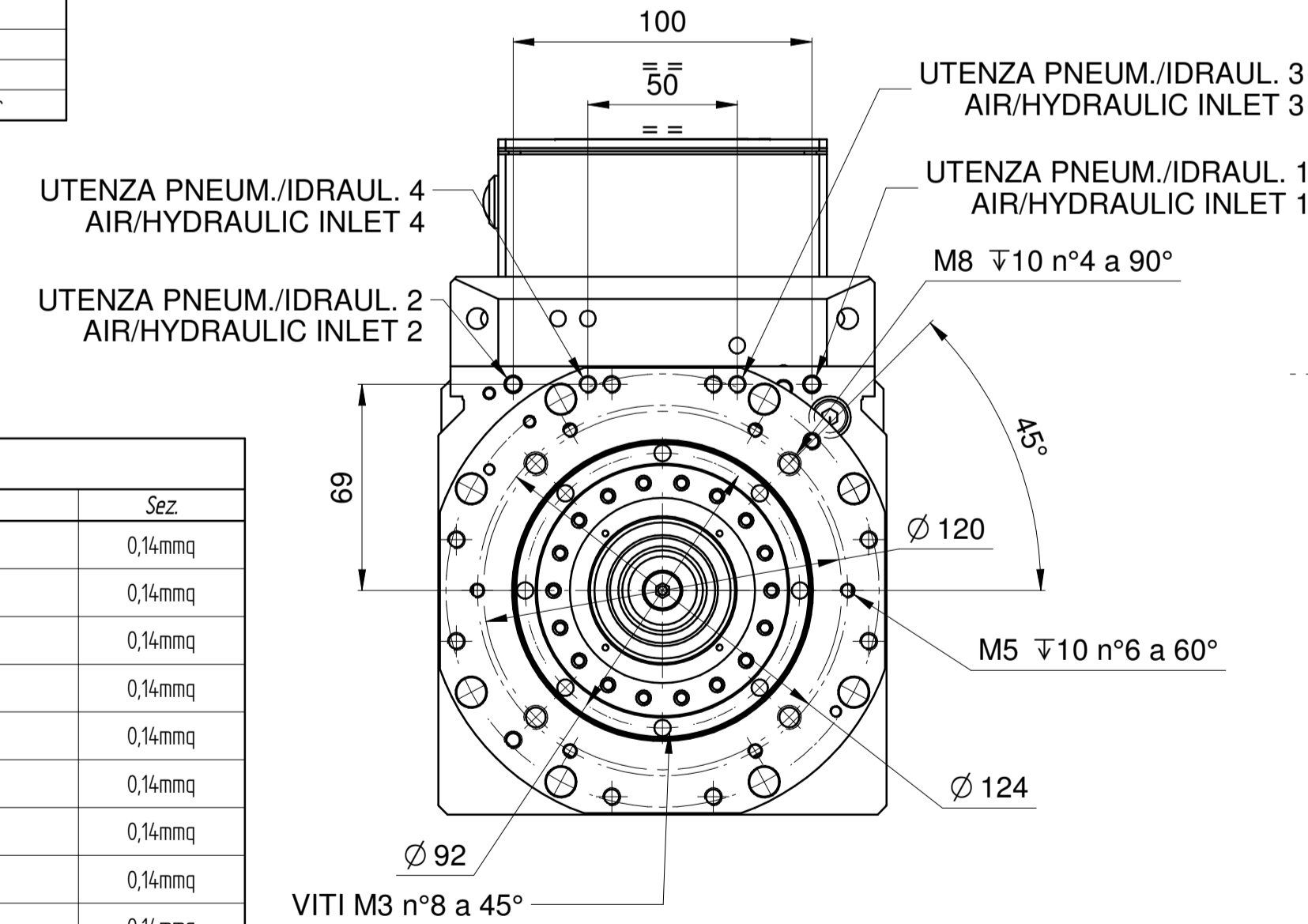
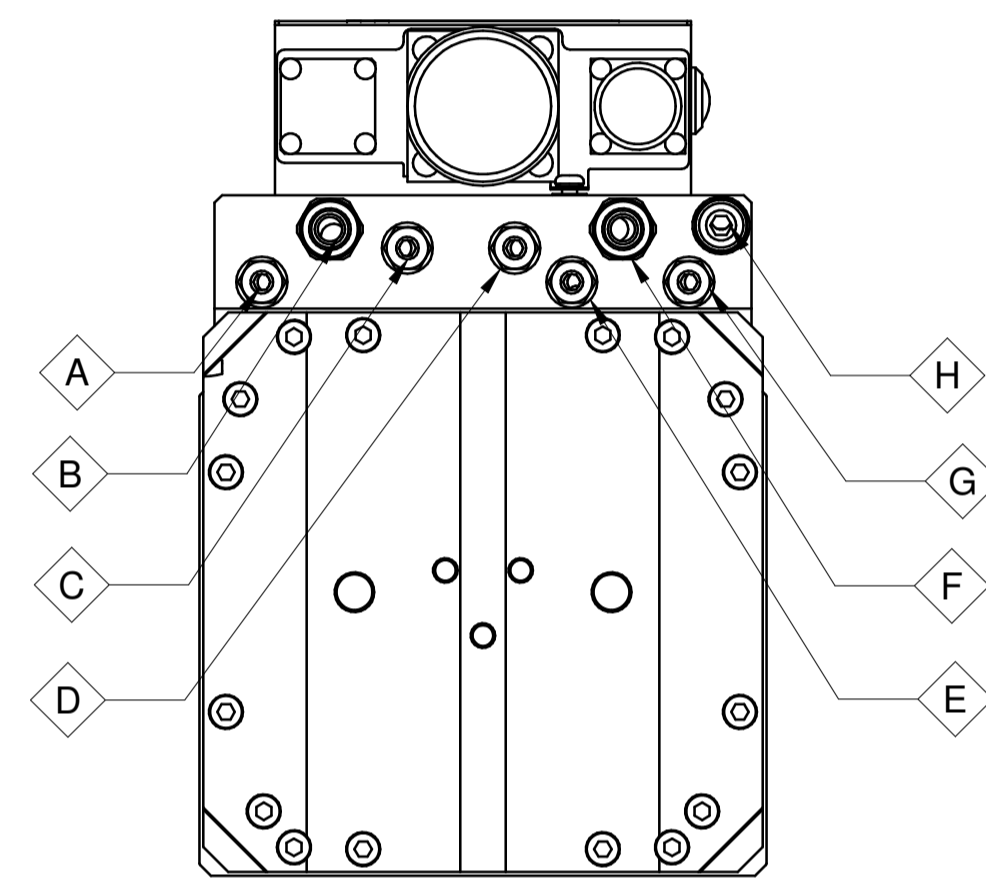
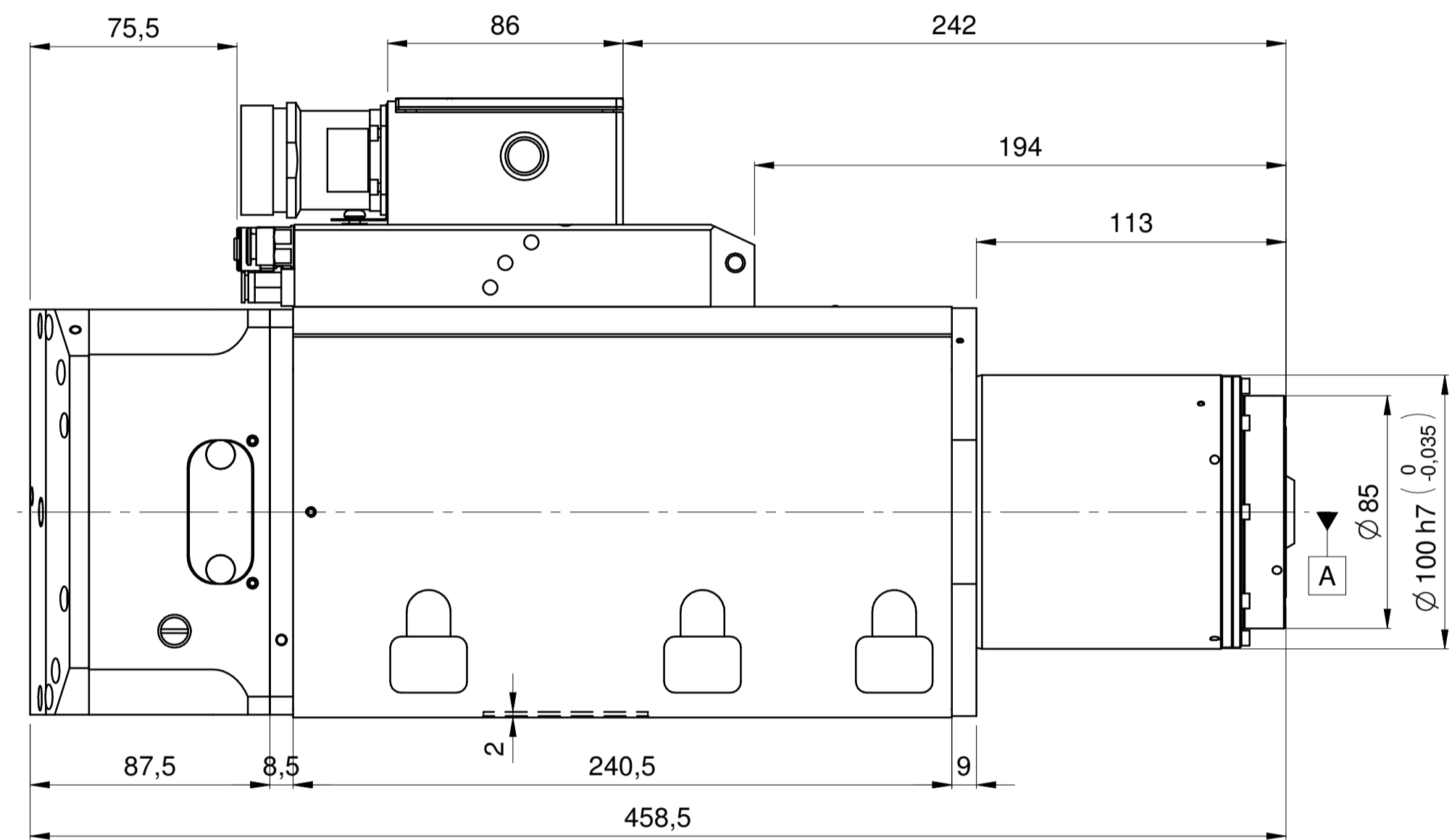
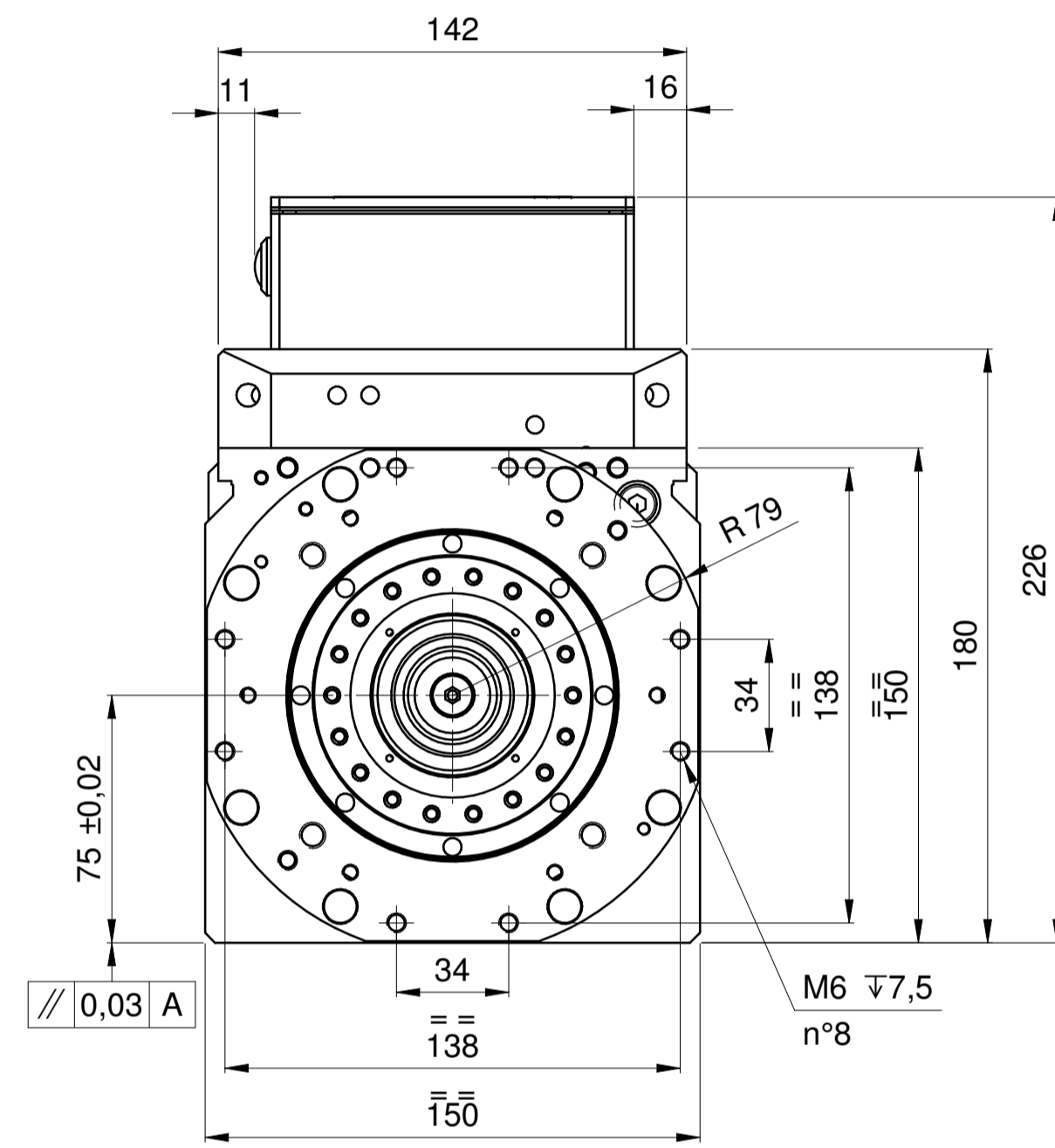

CONNETTORE SEGNALE I/O - SIGNAL I/O CONNECTOR

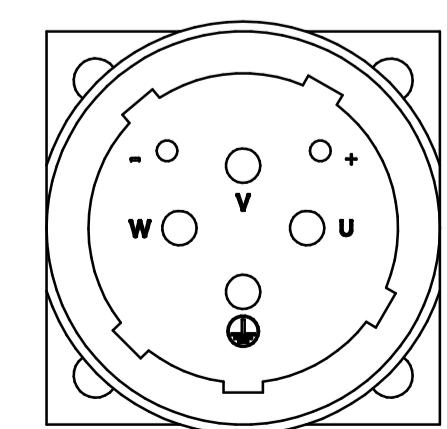

CONNETTORE POTENZA - POWER CONNECTOR

N.C. = NON COLLEGATO - NOT CONNECTED

Rev / Data / Date	Firma / Signature	Descrizione ultima modifica / Last change description	N° Modifica / Change ID
12/12/2018	C. Belardinelli	Verifica / Painting (SCM specific ST231DTG)	Superficie / Surface (PP)
Ultimo rilascio / Latest release		Trattamento Superficiale / Surface Treatment (SCM specifications ST234DTG)	
Controllato / Checked by		Trattamento Termico / Heat Treatment (SCM specifications ST234DTG)	
Disegnato / Drawn by		Peso grezzo/Raw weight (kg)	
C. Belardinelli		CF1 2/0	
12/12/2018		Massa / Mass (kg)	
C. Belardinelli		47,34	
Denominazione / Item Name		Materiale / Material (SCM specifications ST235DTG)	
ELETM HT-2 25/10 24 63E NL 3C		Vedi Tabella	
Scala / Scale		Codice / Item ID	
1:3		29L0502621G	
Denominazione / Item Name		Rev	
ELETM HT-2 25/10 24 63E NL 3C		00	
Scala / Scale		Tav. N. di N.	
1:3		2/2	



HITECO HIGH TECHNOLOGY COMPONENTS